

HOW TO WEBINAIRE

1. Cliquez sur le lien du webinaire sur le site www.lpem.lu
2. Entrez vos informations et le mot de passe (sauf si la case du mot de passe se remplit automatiquement)

Mot de passe : **Webinaire2021**

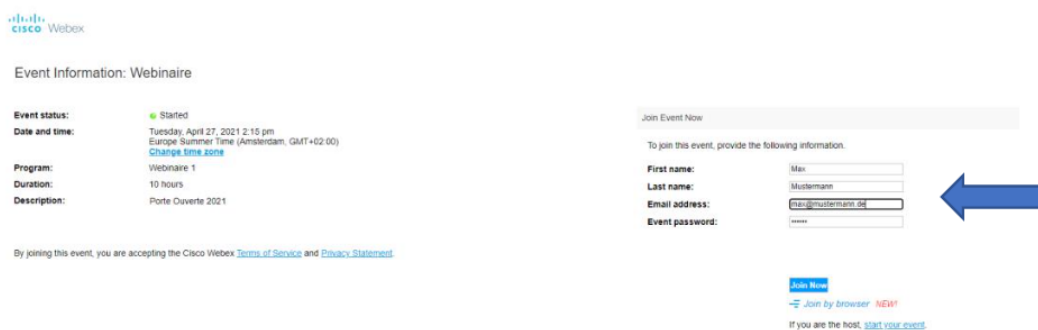

The screenshot shows the Cisco Webex registration interface. On the left, under 'Event Information: Webinaire', the status is 'Started' (indicated by a green dot), the date and time is 'Tuesday, April 27, 2021 2:15 pm' (Europe Summer Time), the program is 'Webinaire 1', the duration is '10 hours', and the description is 'Porte Ouverte 2021'. On the right, the 'Join Event Now' section asks for 'First name', 'Last name', 'Email address', and 'Event password'. The 'Email address' field is pre-filled with 'thomas@mustermann.de'. A blue arrow points to the 'Event password' field. Below the registration form, there are links for 'Join Now', 'Join by browser NEW!', and 'If you are the host, start your event'.

3. Choisissez "Run a temporary application".

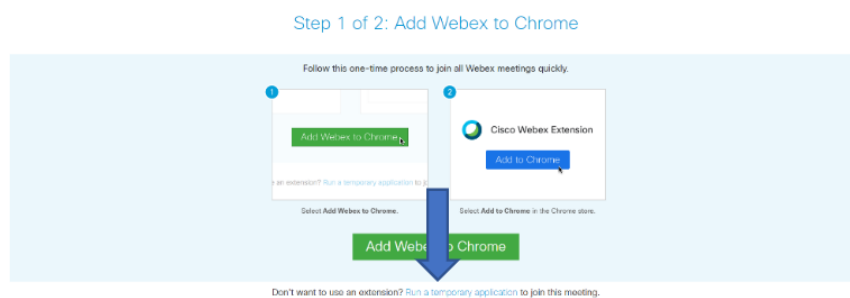

4. Cliquez sur "Join event".

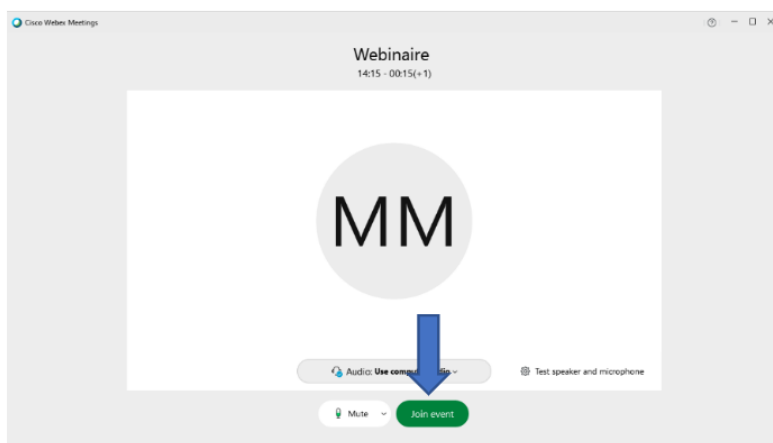

5. Bravo! Vous êtes dans le Webinaire. Pour poser une question, cliquez sur "Q&A".

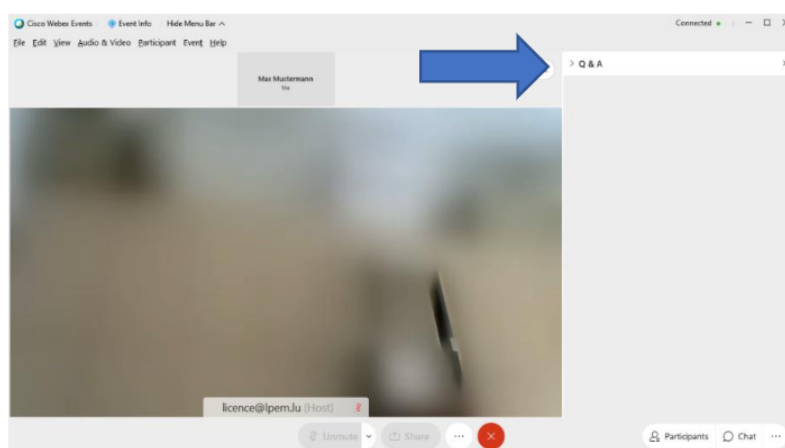

6. Insérez votre question.

